

# MDM – Mobile Device Management of Staff-Owned Devices – Android Phones

## Lincoln College Staff Guide Version 1.0

---

Author: IT Services  
Date: 14.09.2022

# Device Enrollment

---

## Android Phones

Complete the following steps in order to enroll your device

### Step 1

To access an IT resource you will need to enroll your device to ensure it meets our security standards.

Open the Play Store and search for 'Intune Company Portal'.

If you attempt without first enrolling, you will see the following message

Click – Continue

Click – Go to Google Play

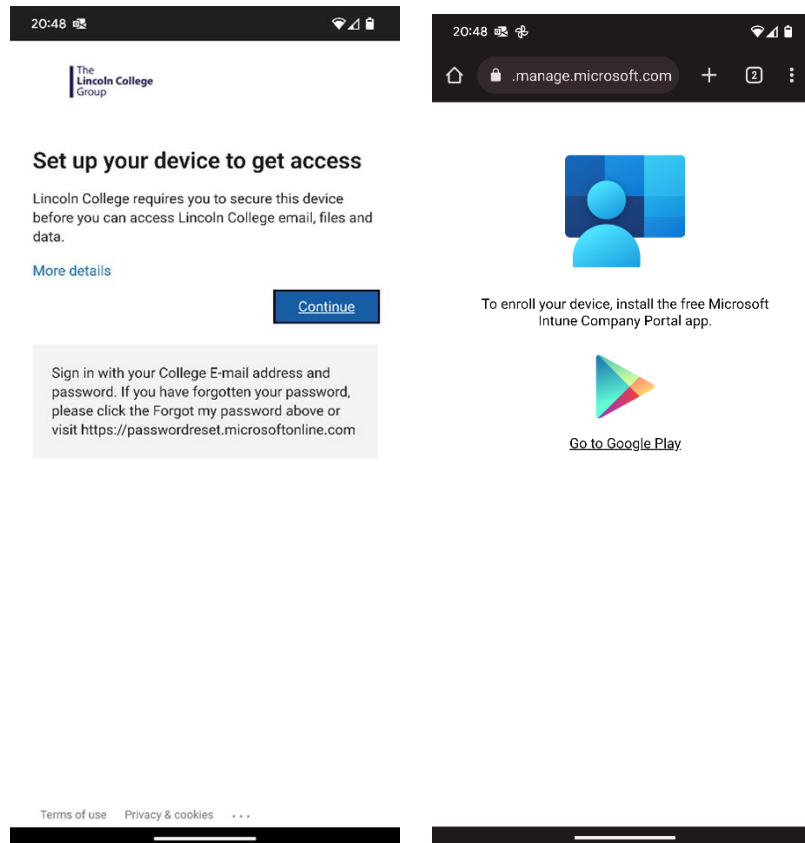

Click – Install

Click - Open

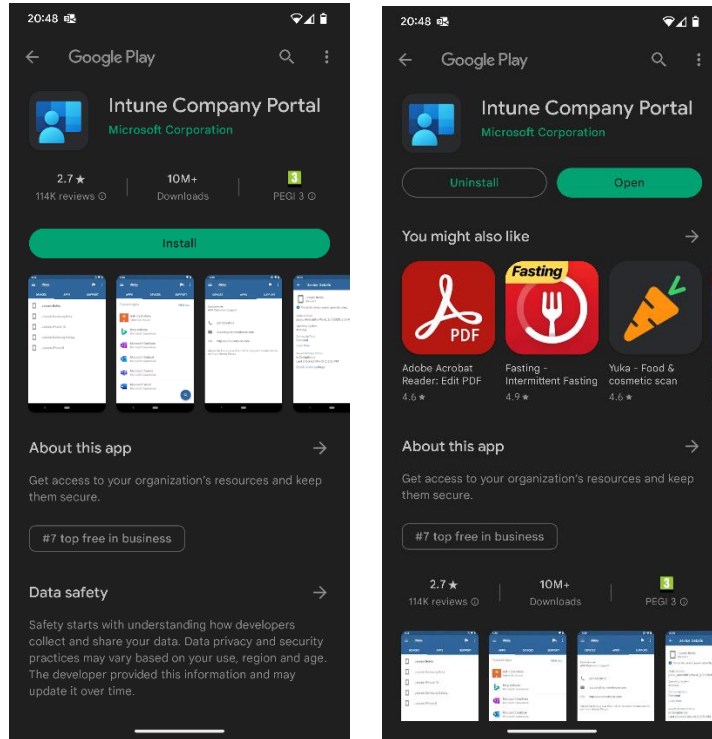

Click - Allow

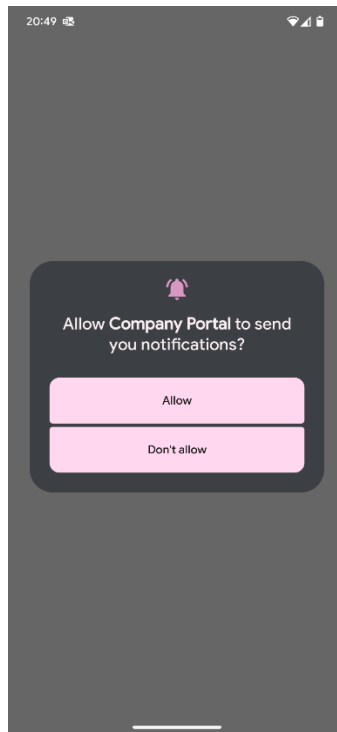

## Click – Sign In

Sign in using your college email address

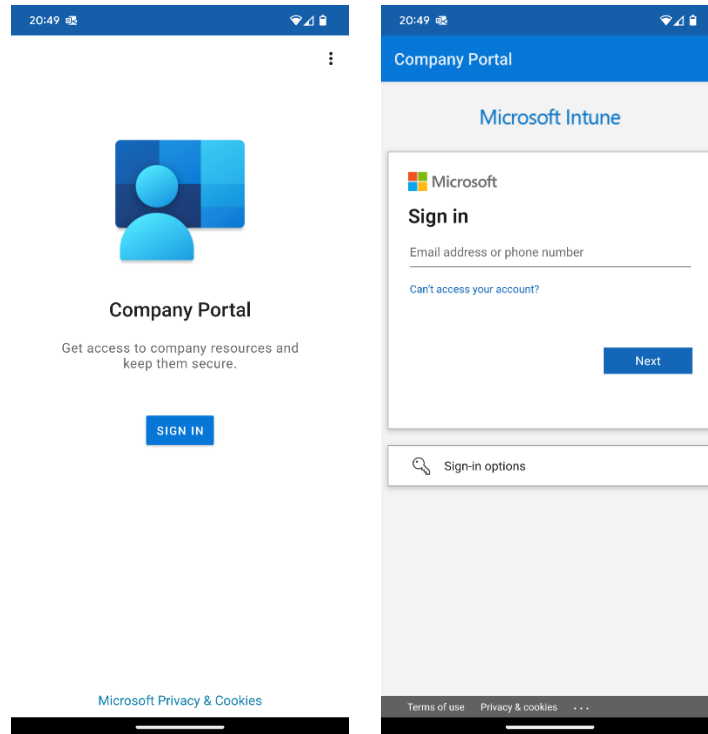

## Enter College Password

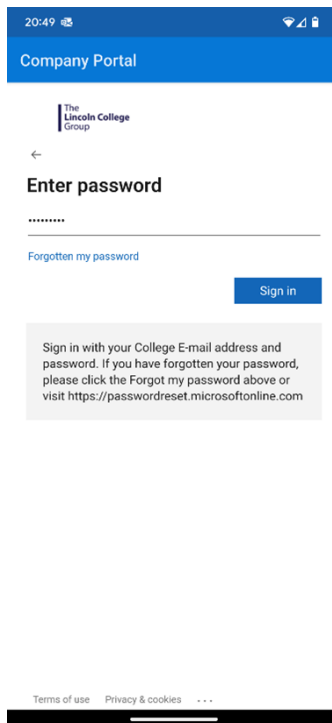

Click – Begin

Click - Continue

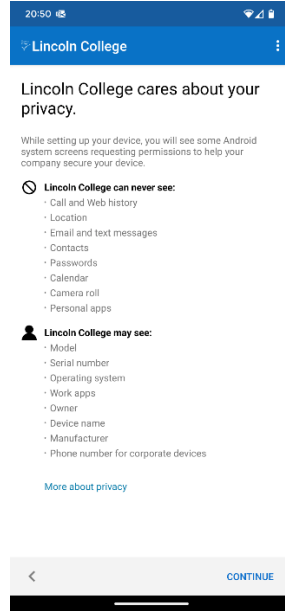
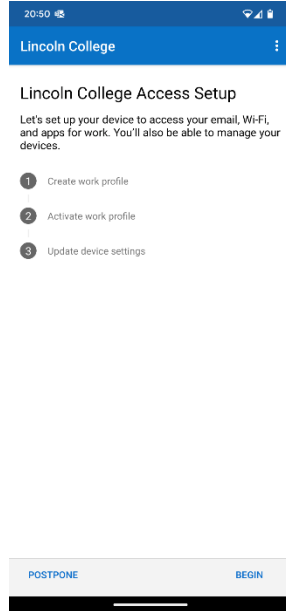

Click – Accept & continue

Click - Next

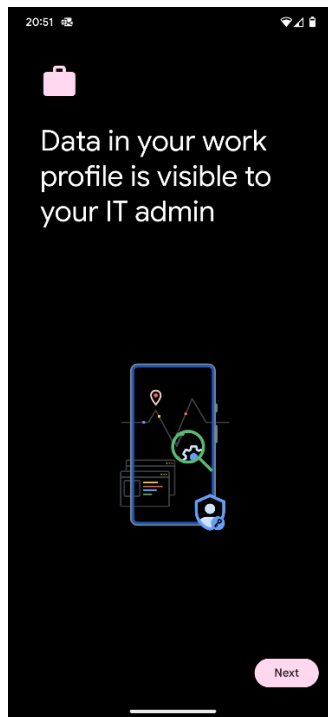
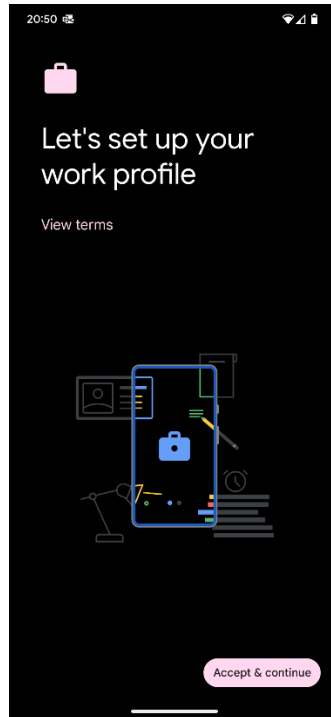

Click – Continue

Click - Done

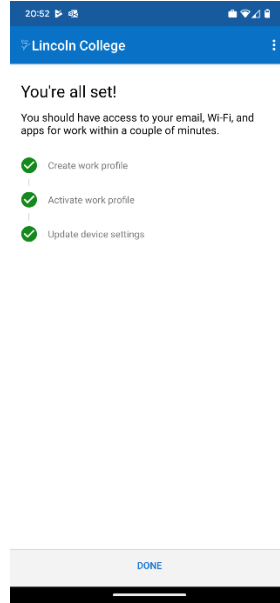
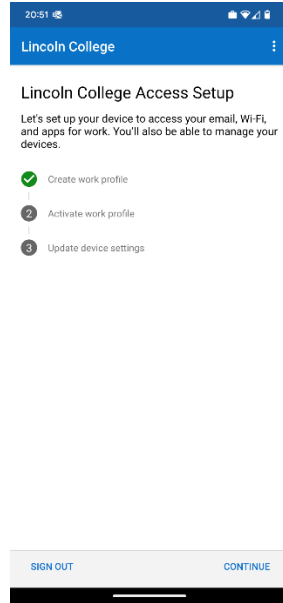

Click – Got It

Click - Dismiss

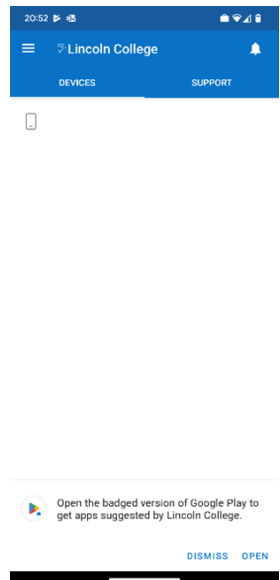
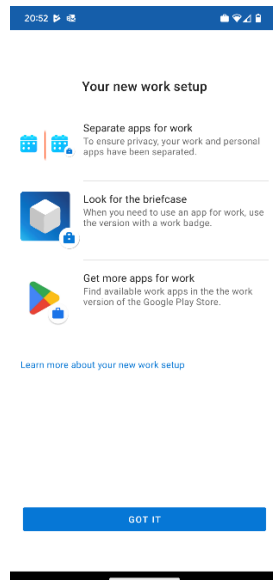

Your mobile phone is now enrolled and will begin downloading a work version of the google play store, indicated by a blue briefcase icon. Select this from the work section of the app draw where you will find a list of authorized apps able to access the Lincoln College network.

Access to Lincoln College IT resources can only be done via these apps.

